



IDLER SPROCKETS POLY CHAIN® GT® AND POWERGRIP® GT®



These idlers are the ideal solution when converting fixed centre distance roller chain drives with Poly Chain® GT® Carbon™ belts. Idlers can be used to take up extra belt length and provide adjustment for tensioning belt drives. Idler pulleys and sprockets can alter belt paths and clear obstructions.

CONSTRUCTION

Gates idler sprockets contain sealed ball bearings and an integral shaft for mounting to Gates adjustable idler brackets.

ADVANTAGES

- > A perfect solution to customising belt drives.
- > Suited to both Poly Chain® GT® Carbon™ and PowerGrip® GT® belts.
- > Lubrication and maintenance are not required.
- > 8MGT 12 and 21mm versions available with nickel plating for improved corrosion resistance.

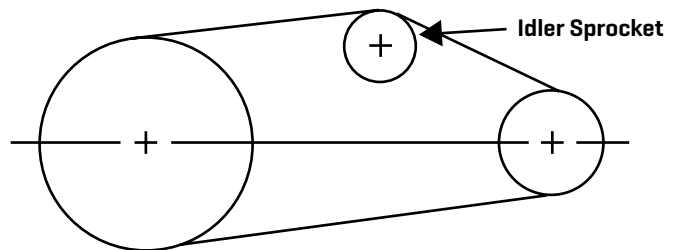

Gates Idler Sprockets can be used with Gates Idler Brackets.

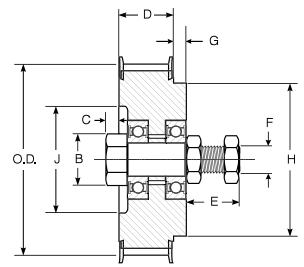

POLY CHAIN® GT® IDLER SPROCKETS

Description	Use with	Size Designation	Belt Width (mm)	No. of Teeth	Outside Dia. (mm)	B Ref. (mm)	C (mm)	D (mm)	E Ref. (mm)	F (Threads)	G Ref. (mm)	H (mm)	J (mm)
12-IDL-SPRK	8mm Pitch Poly Chain GT Carbon belts	8M-32S-12	12	32	79.88	31.75	12.70	21.59	39.62	3/4" - 16	23.88	69.85	-
21-IDL-SPRK		8M-32S-21	21	32	79.88	31.75	12.70	31.50	39.62	3/4" - 16	14.22	69.85	-
36-IDL-SPRK		8M-36S-36	36	36	90.07	48.51	19.05	47.24	41.40	3/4" - 16	-	-	-
62-IDL-SPRK		8M-36S-62	62	36	90.07	48.51	19.05	73.91	42.93	3/4" - 16	17.53	79.50	-
20-IDL-SPRK	14mm Pitch Poly Chain GT Carbon belts	14M-30S-20	20	30	130.89	64.77	25.40	34.54	57.15	1" - 14	25.40	111.25	-
37-IDL-SPRK		14M-30S-37	37	30	130.89	64.77	25.40	52.32	57.15	1" - 14	6.35	111.25	-
68-IDL-SPRK		14M-34S-68	68	34	148.72	85.85	14.22	84.58	57.15	1" - 14	25.40	123.95	110.24
90-IDL-SPRK		14M-34S-90	90	34	148.72	85.85	7.87	106.68	57.15	1" - 14	25.40	123.95	110.24
125-IDL-SPRK		14M-34S-125	125	34	148.72	85.85	4.83	143.00	57.15	1" - 14	27.69	123.95	110.24

POLY CHAIN® GT® CARBON™ IDLER SPROCKETS

Part No.	Product No.	Size	Weight (kg)	Bearing Number	Bearing Jamb Nut Torque (Nm)*	Install Jamb Nut Torque (Nm)	Max Speed (rpm)	Use With Idler Bracket
12-IDL-SPRK	7720-1500	8M-32S-12	0.45	6304	13.6 ±1	54	7700	10-IDL-BRAK
21-IDL-SPRK	7720-1510	8M-32S-21	0.50	6304	13.6 ±1	54	7700	
36-IDL-SPRK	7720-1520	8M-36S-36	0.91	6306	13.6 ±1	54	6800	
62-IDL-SPRK	7720-1530	8M-36S-62	0.95	6306	13.6 ±1	54	6800	
20-IDL-SPRK	7720-1600	14M-30S-20	4.09	6308	20.3 ±2	68	4700	20-IDL-BRAK
37-IDL-SPRK	7720-1610	14M-30S-37	5.45	6308	20.3 ±2	68	4700	
68-IDL-SPRK	7720-1620	14M-34S-68	7.09	6310	20.3 ±2	68	4100	
90-IDL-SPRK	7720-1640	14M-34S-90	7.59	6310	20.3 ±2	68	4100	
125-IDL-SPRK	7720-1630	14M-34S-125	10.50	6310	20.3 ±2	68	4100	

POWERGRIP® GT® IDLER SPROCKETS

Description	Use with	Size Designation	Belt Width (mm)	No. of Teeth	Outside Dia. (mm)	B Ref. (mm)	C (mm)	D (mm)	E Ref. (mm)	F (Threads)	G Ref. (mm)	H (mm)	J (mm)
20-SPK2-IDL	8mm Pitch PowerGrip GT3 belts	P32-8MGT-20	20	32	80.11	31.75	12.70	31.50	39.62	3/4" - 16	14.22	69.85	-
30-SPK2-IDL		P36-8MGT-30	30	36	90.30	48.51	19.05	47.24	41.40	3/4" - 16	-	-	-
40-SPK2-IDL	14mm Pitch PowerGrip GT3 belts	P30-14MGT-40	40	30	130.89	64.77	25.40	52.32	57.15	1" - 14	6.35	111.25	-
55-SPK2-IDL		P34-14MGT-55	55	34	148.72	85.85	14.22	84.58	57.15	1" - 14	25.40	123.95	110.24

POWERGRIP® GT® IDLER SPROCKETS

Part No.	Product No.	Size	Weight (kg)	Bearing Number	Bearing Jamb Nut Torque (Nm)*	Install Jamb Nut Torque (Nm)	Max Speed (rpm)	Use With Idler Bracket
20-SPK2-IDL	7720-1740	P32-8MGT-20	0.50	6304	13.6 ±1	54	7700	10-IDL-BRAK
30-SPK2-IDL	7720-1750	P36-8MGT-30	0.91	6306	13.6 ±1	54	6800	
40-SPK2-IDL	7720-1850	P30-14MGT-40	5.45	6308	20.3 ±2	68	4700	20-IDL-BRAK
55-SPK2-IDL	7720-1860	P34-14MGT-55	7.09	6310	20.3 ±2	68	4100	

GATES AUSTRALIA PTY LTD

1-15 Hydrive Close, Dandenong South, Victoria, 3175

PH: +61 3 9797 9666 FAX: +61 3 9797 9600

February 2015