

THINK: I-100 & R-150

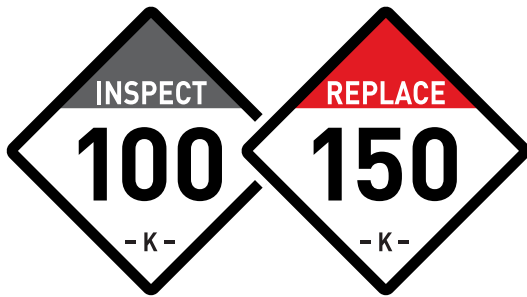

System failures can lead to expensive engine repairs. The best way to prevent this is to remember to start inspecting the serpentine systems at 100,000 km and replace worn components by 150,000 km or as advised by the manufacturer.

The Gates brand of serpentine system replacement parts is trusted by vehicle manufacturers, recommended by quality mechanics and relied on by motorists. Be sure to use Gates parts when it's time for replacement.



What are the risks when you only replace one part of the system rather than the belt and components as well?

- > A common misnomer is thinking the drive belt is the cause of belt noise, when in fact it usually is caused by an external source.
- > Insufficient charging from the alternator
- > Possible overheating from inferior cooling system performance
- > Belt noise can reoccur
- > May cause the check engine light to illuminate
- > Could result in a misdiagnosis of the check engine light

**GATES AUSTRALIA PTY LTD**  
1-15 Hydrive Close  
Dandenong South,  
Victoria 3175  
+61 3 9797 9666  
[GatesAustralia.com.au/systemsmart](http://GatesAustralia.com.au/systemsmart)



**BE SYSTEM SMART**

## STAY ON THE MOVE

Protect yourself and your investment from inconvenient breakdowns and expensive repairs by fully maintaining your vehicle's critical serpentine belt drive system. Inspect the system at 100,000kms and replace worn components at 150,000kms.

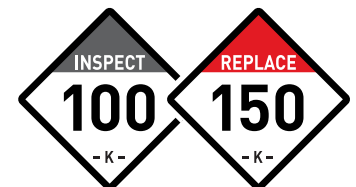



## SERPENTINE SYSTEM

## HOW TO USE THE NEW BELT WEAR GAUGE

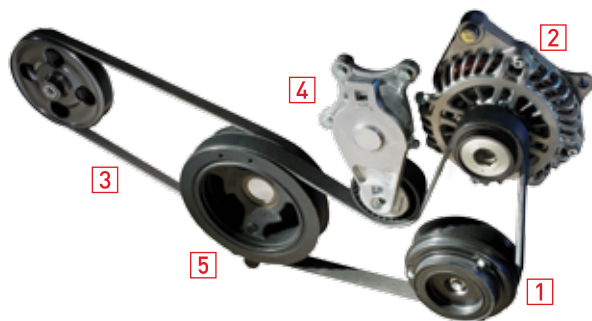

Belt drive components are wear parts, not hard parts. Gates has ALL the required components for a complete serpentine system replacement.

Be system smart and repair the full serpentine system, and not just a single part, to avoid breakdowns. Including:

### 1 Idler Pulleys

Smoothly connects the belt to the system. Worn pulleys can misalign and cause system damage.

### 2 Alternator Decoupler Pulley

Transfers power from the belt to the alternator, keeping the battery charged. Wear is a common cause of charging problems.

### 3 Serpentine Belt

Powers many key components like the alternator and air conditioner compressor. Just 5% wear can negatively affect performance.

### 4 Belt Tensioner

Maintains consistent tension on the belt. A loss of tension can create noise and heat, leading to premature belt failure.

### 5 Torsional Vibration Dampers

Crankshaft pulley with a rubber damping element to absorb vibrations from the crankshaft and extend the lifespan of the crankshaft, the multi-ribbed belt and all belt-driven components.

Gates Australia introduces its innovative new Belt Wear Gauge tool for serpentine belt inspection. Designed with input from professional technicians, the small, lightweight tool provides a simple and reliable way to determine belt wear by gauging material loss between belt grooves and providing instant pass/fail results.



With the engine off, press the gauge ribs into the belt grooves using gentle pressure to hold the gauge against the belt and seat the ribs.

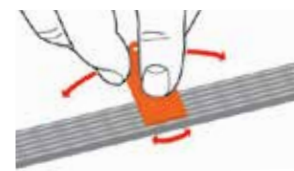

Attempt to rock the gauge in a lateral motion.

### GOOD BELT



When the gauge remains tightly seated and resists movement, the belt has sufficient service life left.



The gauge ribs will contact the sides of the belt material and the body may rest slightly above the belt surface.

### WORN BELT



When the gauge allows lateral rocking motion, the belt is in need of replacement.



The gauge ribs will not contact the belt material and the gauge body will rest flat on the belt, allowing movement in the tool.



Check belts for inconsistent wear within grooves indicating pulley misalignment or a malfunction of other components of the drive system.

Request a Gates Wear Gauge at: [www.GatesAustralia.com.au/beltwear](http://www.GatesAustralia.com.au/beltwear)

